

City of Mineral Point Corporate Limits Map

Iowa County, WI

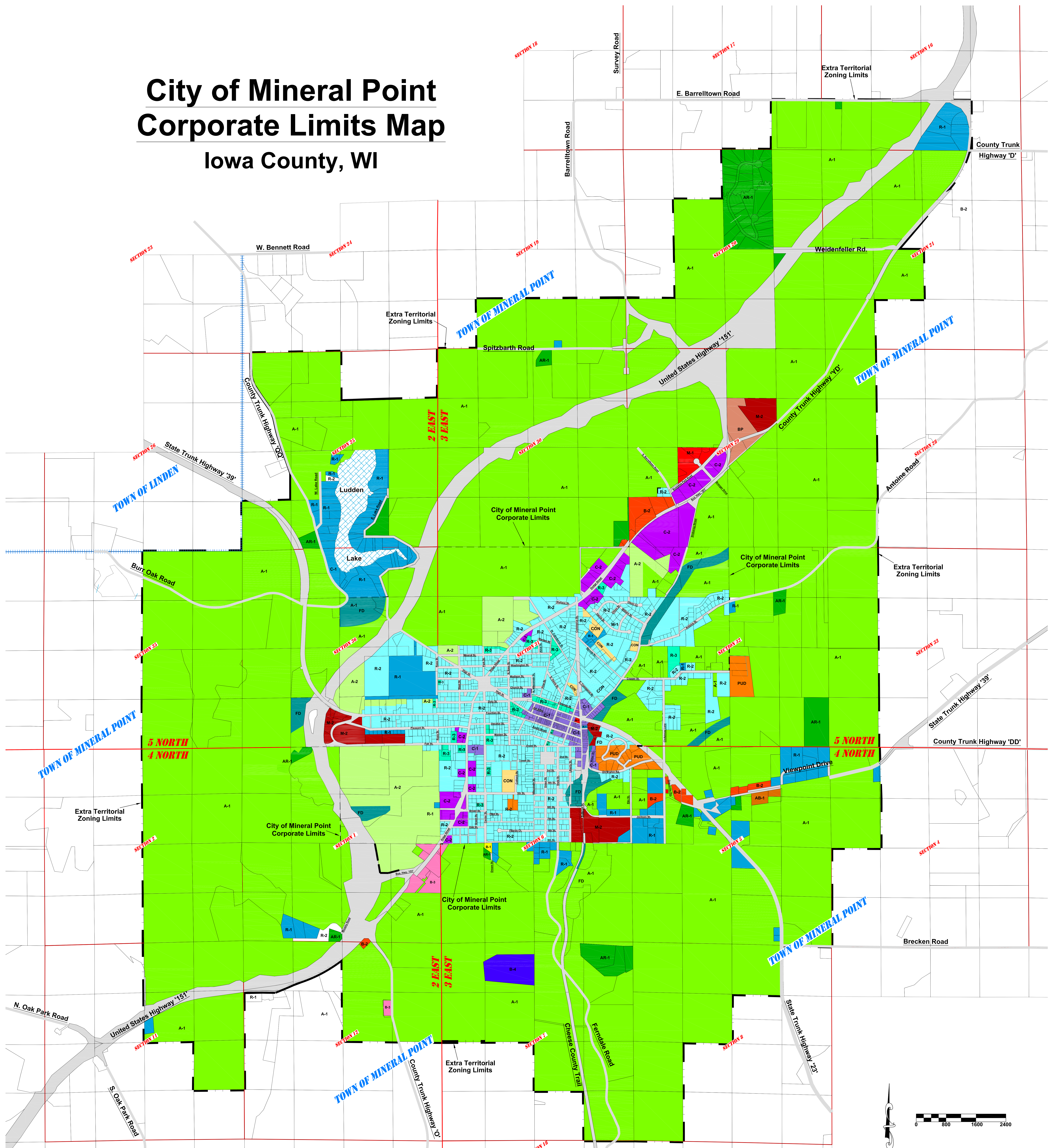

MAP LEGEND

- | | |
|--|---------------------------------------|
| R-1 Single-Family Residential District | B-1 Local Business District |
| R-2 Two-Family Residential District | B-2 Highway Business District |
| R-3 Multiple-Family Residential District | B-3 Heavy Business District |
| R-4 Mobile Home Residential District | B-4 Industrial Business District |
| C-1 Central Business District | CON Conservancy District |
| C-2 Highway Commercial District | PUD Planned Unit Development District |
| M-1 Light Industrial District | FD Flood Hazard District |
| M-2 Heavy Industrial District | BP Business Park District |
| A-1 Agricultural Preservation District | Right-of-Way/Local Roads |
| A-2 Agricultural Transition District | Water Bodies |
| AR-1 Agricultural Residential | Historic District Boundary |
| AB-1 Agricultural Business | Corporate Limits |
| | Extra Territorial Zoning Limits |
| | Section Boundaries |
| | Township Boundary |
| | Parcel Boundary |

Map Prepared By:

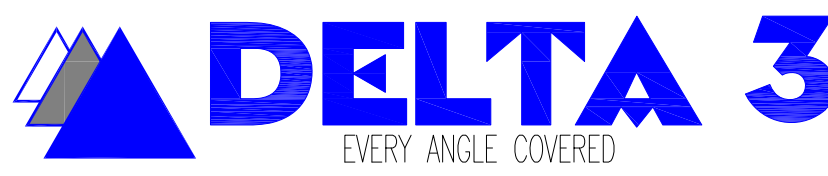

PROFESSIONAL CIVIL, MUNICIPAL, & STRUCTURAL ENGINEERING • ARCHITECTURE
GRANT WRITING • LAND DEVELOPMENT • PLANNING & CAD SERVICES

875 SOUTH CHESTNUT STREET PHONE: (608) 348-5355
PLATEVILLE, WISCONSIN 53818

898 JACKSON STREET PHONE: (563) 542-9005
DUBUQUE, IOWA 52001

The information on this map was obtained from documents provided by the City of Mineral Point. The intent of this map is to show the approximate lot locations and zoning districts in the City of Mineral Point and its Extra Territorial Zone. This map is not an official survey document nor have any surveys or title searches been completed to verify the actual location and dimensions of lots shown.